

Starting at the western most point of Lot 525 on Plan SP164801, then on a bearing of 56.675 degrees for a distance of 66.505 metres, then 170.6194 degrees for 250.444 metres, then 68.9958 degrees for 173.579 metres, then 68.0472 degrees for 101.735 metres, then 95.55 degrees for 56.26 metres, then 128.533 degrees for 87.36 metres, then 111.789 degrees for 35.54 metres, then 133.45 degrees for 51.27 metres, then 72.9292 degrees for 6.645 metres, then 78.1083 degrees for 14.32 metres, then 88.4667 degrees for 14.32 metres, then 498.825 degrees for 14.32 metres, then 109.179 degrees for 14.32 metres, then 114.357 degrees for 10.045 metres, then 112.283 degrees for 31.19 metres, then 199.617 degrees for 19.57 metres, then 194.908 degrees for 35.355 metres, then 199.292 degrees for 21.77 metres, then 208.087 degrees for 21.77 metres, then 216.833 degrees for 21.77 metres, then 225.608 degrees for 21.77 metres, then 229.992 degrees for 40.665 metres, then 224.942 degrees for 20.755 metres, then 214.829 degrees for 20.755 metres, then 209.775 degrees for 17.165 metres, then 275.602 degrees for 13.4416 metres, then 276.683 degrees for 697.69 metres, then 338.831 degrees for 22.195 metres, then to point of commencement.

INSET - metes and bounds - Lot 525 on SP164801

Refer to Inset for metes and bounds

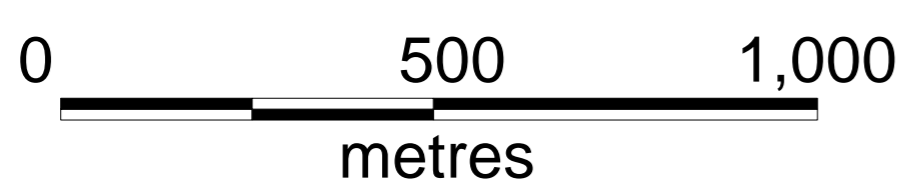
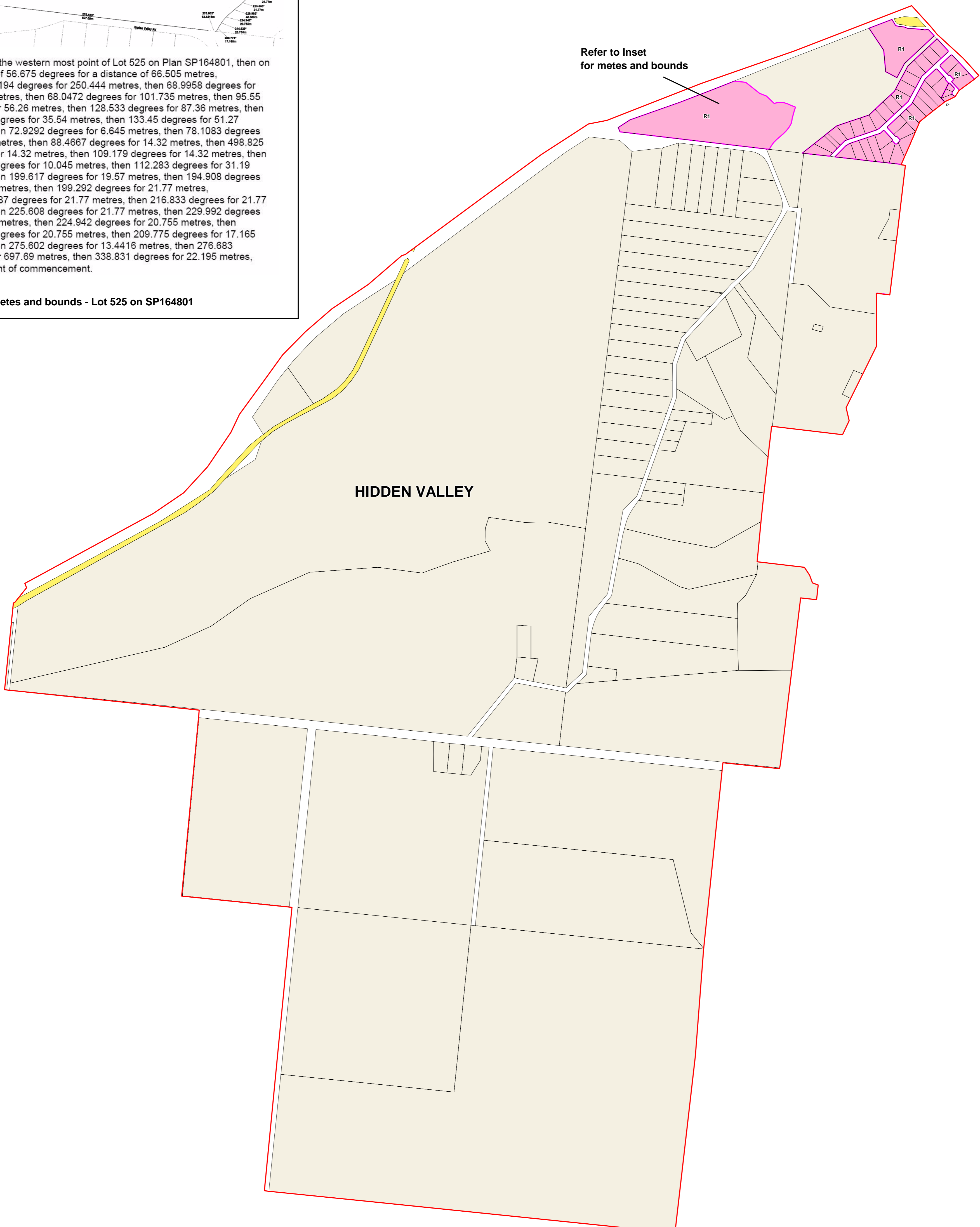

ZONES	PRECINCTS
Special Purpose	R1 Residential 1
Open Space	R2 Residential 2
Rural	R3 Residential 3
Residential	LI Light Industry
Comprehensive Development	GI General Industry
Park Residential	
Business	
Industry	
Village	
Yeppoon Central	

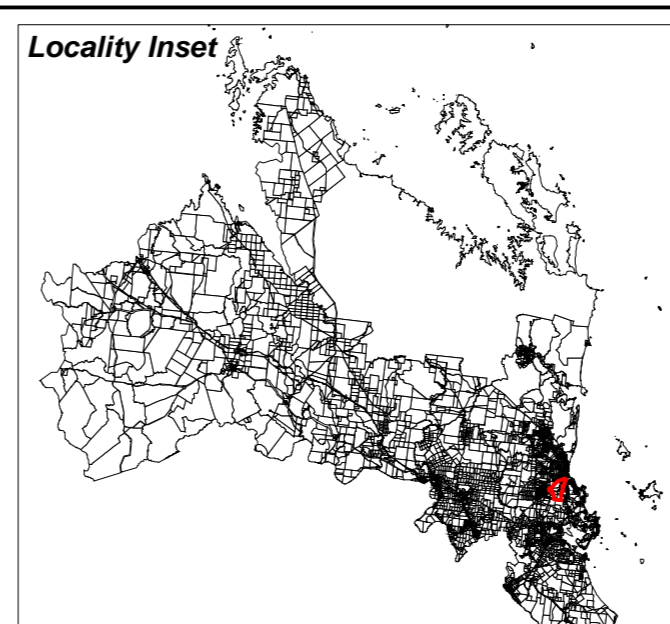

Planning Scheme 2005
living for lifestyle
Zoning Map
Z30
 Hidden Valley
Commencement date: 17 October 2005

This publication has been produced by the Livingstone Shire Council and is based on cadastral data provided with the permission of the Department of Natural Resources
 © 2000 State of Queensland (Department of Natural Resources) and Livingstone Shire Council